



Model

NS350AG

Product Description

Slicer, 350mm, Automatic, Extra Heavy Duty, Gear Driven

Product Code

5S516N

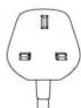

Standard Features

- Automatic slicer designed to cut large quantities of food. Suited to large restaurants, supermarkets, delis, butchers and central production kitchens / canteens, where high volume slicing of a variety of meat types is required, and precise control of the automatic slicing feature is necessary
- Extra heavy duty, gear driven machine, designed to effortlessly handle heavy loads like bacon and large pieces of meat that might cause slipping and/or blade stoppage on a belt driven machine
- Two independent motors (one for blade and one for carriage movement)
- Can be used as a fully automatic slicer or switches to manual
- Simple, intuitive touch control panels allow for the selection of multiple slicing options
- Optional slice counter available
- Hollow ground chromed carbon steel blade
- Easy set thickness control allows for precision slicing
- Made from high polished, anodised food grade aluminium for durability and hygiene
- Large base to ensure slicer has a large capacity to cope with large products
- Ergonomic design with smooth, rounded edges to allow for fast and easy cleaning and improved levels of hygiene
- Fully interlocked and safe guarded for full compliance of CE legislation. This ensures all-round blade protection for the ultimate user safety during cleaning
- Built-in, self-aligning sharpening and de-burring unit
- Table / carriage, blade cover, blade and sharpening unit are detachable for easy, safe cleaning
- Optional voltages and frequencies available on request
- CE Approved

Standard Accessories

- 1 x Knife Remover
- 1 x Flat Head Screwdriver
- 1 x Tasteless Oil

Warranty

Covered by Metcalfe 2-year warranty (1st year parts and labour, 2nd year parts only) and full after sales service

Optional Accessories

| Item |
|-------------------------------|
| Stainless Steel Knife Remover |
| Stainless Steel Guard |
| Aluminium Knobs |
| Plastic Cover – Medium |

| Item |
|--|
| Slice Counter |
| Serrated Blade |
| Painting Customisation |
| Teflon Coated Parts (Blade Cover, Gauge Plate, Blade) |

Drawing

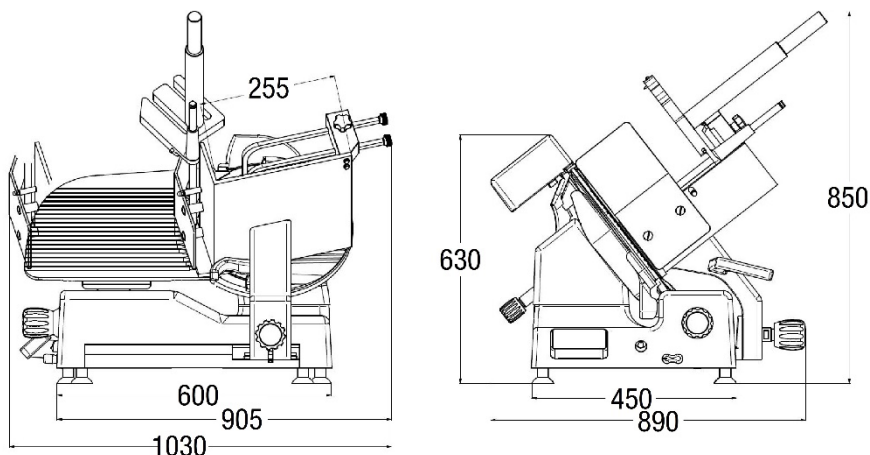

Specifications

| Model | Blade (mm) | Phase (Ø) | Motor (Volt) | Frequency (Hz) | Current (Amp) | Power (kW) |
|---------|------------|-----------|--------------|----------------|---------------|------------|
| NS350AG | 350 | 1 | 220 | 50 | 2.59 | 0.57 |

Capacity

| Model | Cutting Capacity (mm) | | Carriage Movement (mm) | Max Slice Thickness (mm) | Slices Per Min |
|---------|-----------------------|-------------|------------------------|--------------------------|-----------------|
| NS350AG | ● 250 | □ 250 x 280 | 365 | 20 | Min 25 – Max 86 |

Dimensions | Shipping Information

| Model | Overall Dimensions D x W x H (mm) | Net Weight (kg) | Packed Dimensions D x W x H (mm) | Packed Weight (kg) | Volume (m3) |
|---------|-----------------------------------|-----------------|----------------------------------|--------------------|-------------|
| NS350AG | 890 x 1030 x 850 | 64 | 800 x 890 x 800 | 68 | 0.57 |

We reserve the right to alter the specification and technical details for this item at any time without prior notice.

10/2024

Metcalfe Catering Equipment Ltd

Haygarth Park

Blaenau Ffestiniog

Gwynedd, LL41 3PF

