

CEADO X1

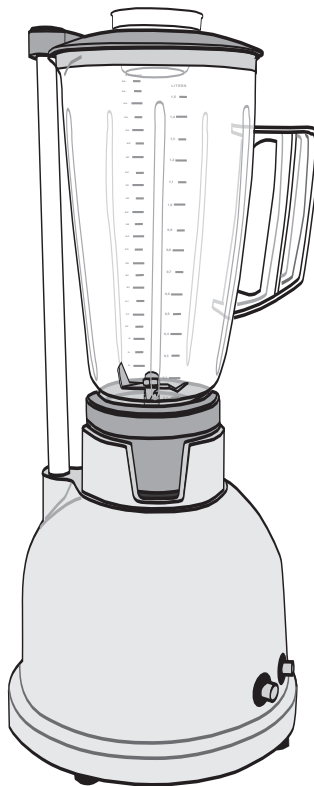

COMMERCIAL BLENDER USE AND MAINTENANCE MANUAL



COMMERCIAL BLENDER

Main parts of the appliance (Fig. 1) (Model with 1.5 lt polycarbonate container)

- | | | | |
|----------|-----------------|-----------|-----------------------|
| 1 | Motor base | 8 | Container base |
| 2 | Container | 9 | ON-OFF-PULSE switch |
| 3 | Lid | 10 | HIGH/LOW speed switch |
| 4 | Filler cap | 11 | Gasket |
| 5 | Magnetic sensor | 12 | Blade assembly |
| 6 | Safety arm | 13 | Collar |
| 7 | Blade | | |

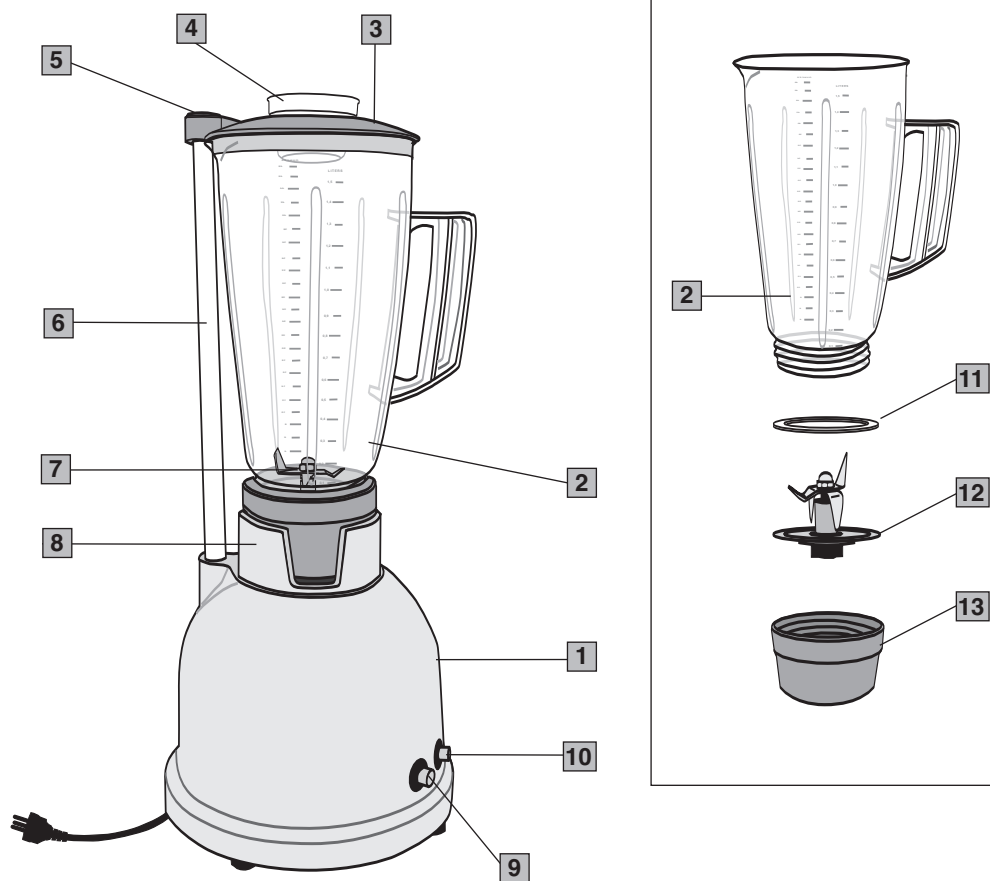
**Fig. 1**

Model with 1.5 lt polycarbonate container

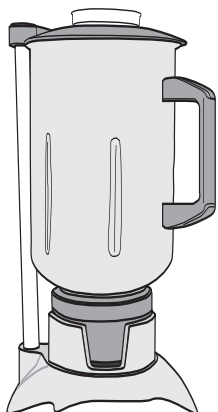

Model with 2.5 lt stainless steel container

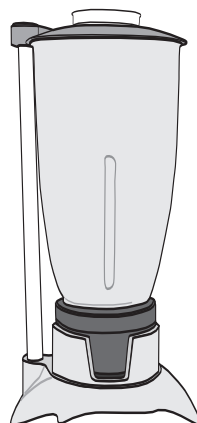

Model with 1.5 lt stainless steel container

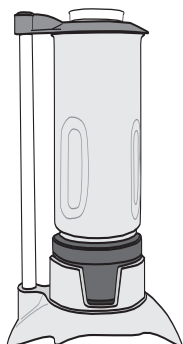

Model with 0.9 lt stainless steel container

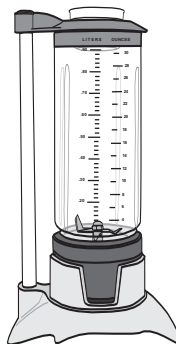

Model with 0.9 lt polycarbonate container

Fig. 2

SAFETY RECOMMENDATIONS GENERAL INSTRUCTIONS

1. Read the following instructions carefully before using the appliance.
2. Installation and any maintenance should be carried out by specialized personnel.
3. This appliance is intended for professional use, and should therefore be used by adults and qualified personnel only.

CLOSE ADULT SUPERVISION IS NECESSARY WHEN CHILDREN ARE NEAR THE APPLIANCE.

4. **Never** use this appliance for any operations other than blending foods. Any other use is dangerous.
5. Always work under safe conditions: do not use the appliance with wet hands or feet. **Do not use outdoors.**
6. Keep the original package for possible future use. It is the most suitable protection against impact during transportation.
7. In case of fire use CO₂ extinguishers. Do not use water or powder extinguishers.
8. **Never** place the appliance in water!
9. Do not disassemble the appliance or attempt to perform any repairs inside it.
10. Always unplug the appliance before performing any maintenance or cleaning of the motor base, and when the appliance is not in use.
11. **Never** pull the appliance by the cord to move it. **Never** unplug it by pulling the cord or touching it with wet hands.



If the cord is damaged, it must be replaced by an Authorized Service Center.

12. The appliance is equipped with a safety device to prevent any contact with moving parts.
DO NOT ATTEMPT TO BY-PASS THE SAFETY DEVICE.
13. **WARNING:** Never place any utensils, metal or other hard materials, in the container. This is dangerous and could cause damage.
14. **Never** operate the appliance with the container empty and never run it for more than 15 seconds if there are no liquids in the container.
15. **Do not** use the appliance if it is damaged or had any loosened parts such as blades, couplings, etc. In these cases, contact an Authorized Service Center immediately.
16. **WARNING: BLADES ARE SHARP. HANDLE WITH CARE!**

SAVE THESE INSTRUCTIONS!

INSTALLATION

Comply with the **safety recommendations** indicated above and hereafter when installing the appliance.

1. Make sure that the mains voltage is as indicated on the rating label of the appliance and that the electric system is grounded and equipped with a differential switch.
 2. Install the appliance in a **DRY, PROTECTED place**, far from water sprays or splashes, heat sources, open flames and inflammable substances.
Place the blender on a **flat, horizontal, stable surface** where it cannot tip over.
 3. Make sure the switch on the appliance is in the "OFF" position and plug it into a socket protected by a magneto thermal switch or fuses.
Do not use a multiple outlet plug.
 4. Stretch the power cable out to full length. **Do not** let it pass over sharp edges or hot surfaces. **Do not** let oil spill on it. **Do not** let the power cable hang loose from the counter on which the blender stands.
-

USE

- 1 Place the ingredients in the container in this order: first liquids and fruit, then ice and other solid foods.
- 2 Stand the container on the base fitting it into its support as shown in figure 3.
- 3 Fit the lid on the container so that the magnetic sensor is in contact with the end of the safety arm.
Note: When new, the lid of blender may require extra force to apply and remove. After a few times it will fit perfectly.



Any attempt to by-pass the safety device and use the blender without its lid may cause personal injury and/or damage to the appliance.

- 4 Select the desired speed and, holding one hand on the lid, select ON/OFF/PULSE switch to "ON" - Fig. 4.
 - 5 Most drinks require blending at high speed. Turn the switch to "LOW" only when preparing small quantities or when using the blender just to mix the ingredients.
 - 6 You can use the "PULSE" function by pressing the ON key part way when preparing dense drinks that tend to "float" or to break up nuts or other ingredients that are unable to circulate in the working zone of the blades.
 - 7 The blender is also designed to crush ice and prepare FROZEN DRINKS from ice in cubes. Remember that if you place the ice in the container already crushed this will greatly extend the life of the appliance.
-

- 8** The blender is designed to ensure perfect preparation of the FROZEN DRINKS recipes contained in the international texts of the IBA associations. If you use the quantities indicated in those recipes you will always obtain the desired consistency.

Certain preparations may cause cavitation of the blender. This means the ratio of liquid to ice is not correct. If this occurs, switch the blender off, remove the lid, stir the mixture with a spoon and try again.

- 9** If you have to heat or chill a preparation made with the blender, do not place the container directly in the oven or freezer. This could damage it. Empty the container into a suitable vessel.

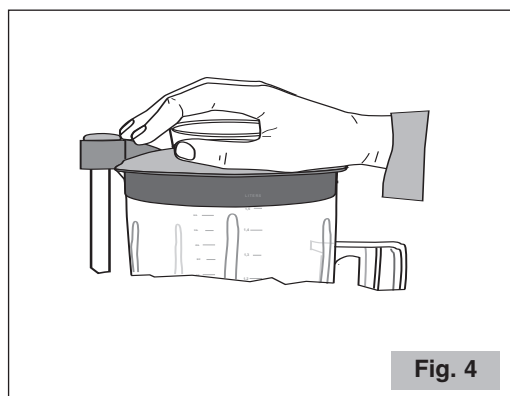
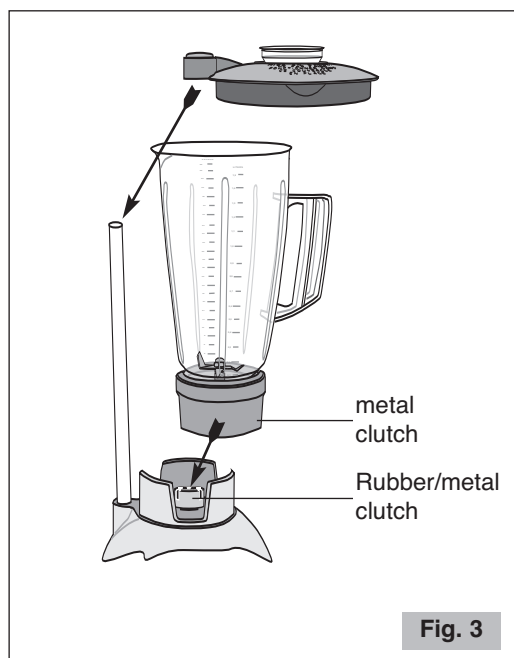

CLEANING AND MAINTENANCE

It is important to keep the appliance clean and in good working order to ensure optimum quality of the products and long life of the appliance. Always rinse the container after use to prevent residues from drying in the container. This could damage the sealing elements and bearings, or cause the blades to seize.

Do not dry the container in the oven or microwave oven.

For longer life of the container we recommend not washing it in the dishwasher.

- **To clean the motor base**, unplug the appliance and clean with a damp cloth or alcohol, or use a generic detergent spray.

Dry with a dry cloth.



Never wash the blender with jets of water or immerse the motor base.

- **To clean the container:** after rinsing the container and lid under the tap, fill the container halfway with warm water and a spoonful of dishwashing detergent. Fit the container on the base, cover with the lid and run for 20 seconds. Remove the container and rinse with running water. Repeat the operation with 1 liter of warm water and 5 ml of bleach. Remove the container, rinse and dry the container by turning it upside down on the drainboard. Wash the lid with warm water and dishwashing detergent.

! Do not expose the lid to temperatures above 60°C. This would damage the magnetic sensor.

- **For thorough periodical cleaning** remove the blades by unscrewing the collar from the container (Fig. 5, 6, 7 and 8).

! WARNING: Blades are sharp! Handle carefully.

Blades are removable for cleaning by means of a pair of pliers and a #10 spanner. Hold firmly in position the horizontal blade with the pliers and unscrew the cap nut moving the #10 spanner **clockwise** (see Fig. 7).

Never try to disassemble holding a different blade! This could damage the blade.

Wash in warm water with dishwashing detergent and use a small brush to remove any solid residue.

Reassemble in reverse order. **To re-assemble blades** change the movement of the #10 spanner to **counterclockwise** (see Fig. 7) tightening securely.

! VERY IMPORTANT: Always remember to position the gasket over the blade assembly.



Unscrewing the collar

Fig. 5



Removal of blade assembly

Fig. 6

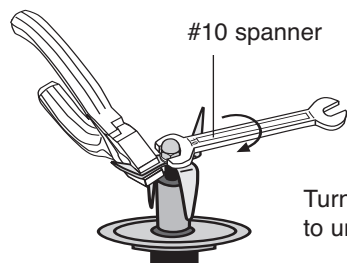

Disassembling blade

Fig. 7

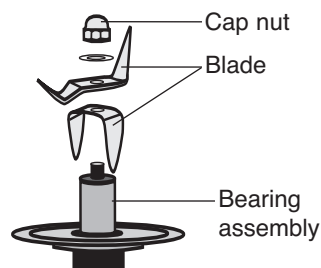

Blade assembly parts

Fig. 8

TROUBLESHOOTING

In case of any malfunction, defect of the appliance or if you suspect any breakage after a fall, unplug the appliance immediately.

If you are unable to solve the problem referring to the table below, contact an Authorized Service center.

Only qualified experts should repair the appliance.

We are not liable for any damage caused by repairs not made correctly by unauthorized personnel. In these cases the warranty does not apply.

Problem	Solution
The blender does not start.	<ul style="list-style-type: none">• Make sure it is plugged in.• Make sure the safety circuit breaker is closed.• Make sure the magnetic sensor in the lid is touching the safety arm.• Make sure the switch on the blender is turned to ON.• If the problem occurs after a long period of intensive use the motor may have overheated. Wait at least 20 minutes and try again. If you put the blender in a cool place this will reduce the waiting time.• If the problem occurs after an overload, the circuit breaker on the motor may have been tripped! Push the button on the back or bottom of the appliance (not standard equipment on all models).• Make sure the blades and motor revolve freely.
The blades do not turn with the motor on.	<ul style="list-style-type: none">• Make sure the rubber clutch is in good condition.• Make sure the container is correctly fitted on the base.
Noise and vibration of container.	<ul style="list-style-type: none">• Make sure the collar, blades and joints are securely tightened.• Make sure the rubber clutch is not damaged.• Try to unscrew and replace the collar.
Leakage of liquid from container.	<ul style="list-style-type: none">• Make sure the collar is tightly fastened.• Make sure the gasket is installed correctly (see Fig. 6).

DISPOSAL

Correct disposal of this product (waste electrical and electronic equipment)

(Applicable in the European Union and other countries with separate collection systems)

This product has been made from high-quality parts and materials, which can be re-used and recycled.

Therefore, do not throw the product away with normal household waste at the end of its working life. Take it to a collection point for recycling electrical and electronic devices. This is indicated by this symbol on the product and in the operating manual.

Please contact your local government office for information about the exact location of the closer collection point.



WARRANTY

This product is guaranteed against defects in the materials or manufacture for a period of two years from the date of purchase when used according to the instructions in this use and maintenance manual.

During the warranty period, this product can either be repaired or replaced, at the manufacturer's discretion, at no additional cost.

If the product needs maintenance or repairs during the warranty period, contact your retailer for shipping instructions. The product should be shipped in its original package or other suitable packing.

The warranty does not apply in case of neglect, improper use or unauthorized repairs. The warranty does not apply, also, to parts subject to wear such as the container, blades, joints, etc.

The warranty is limited to the costs of repair or replacement of the product or its defective parts, or an amount equivalent to the price paid for its purchase. No additional requests of damages will be considered.

The above instructions must be followed, otherwise the warranty is invalidated and the manufacturer has no liability.

In any case these instructions cannot cover every possible condition and the user is recommended to make responsible use of the appliance.

**THE MANUFACTURER RESERVES THE RIGHT TO MAKE ANY ALTERATIONS TO
THE APPLIANCE WITHOUT NOTICE**
