

MANUFACTURER:	Roband Australia
CATEGORY:	Fryers
MODEL / DESC:	Frypod Range
ORIGIN:	Australia
WARRANTY:	1 Year (refer to website)



Frypod Fryers

Performance Excellence | Innovative Design | Safety Features | Easy Clean

The Roband Frypod combines innovative design with strong performance, safety and clean operation. Its highly responsive elements minimise oil temperature drop during cooking, producing consistent results with less oil in the food and longer oil life. With a sleek brushed stainless finish, the Frypods feature a safety lock that stops the elements from being removed while on and prevents operation when they're not in place.

FEATURES

<ul style="list-style-type: none"> • Safety lock mechanism preventing element removal when machine is switched on. It also prevents machine being turned on when elements are removed • Elements swing back & lock in place for draining oil & tank removal • Beveled fryer body providing lip for easy tank removal • Splashguard with bash plate that returns oil into pan for functional and cleaner operation • Precise thermostat control • Maximum & minimum oil level markers • Isolating switch • Insulated basket handle • Element guard & capillary protection 	<ul style="list-style-type: none"> • Safety over-temp cut-out • Pan cover included • All models have basket chip capacity of 1 Kg <p>FR15 & F18 Fryers</p> <ul style="list-style-type: none"> • Single basket in a single pan fryer <p>FR111 Fryer</p> <ul style="list-style-type: none"> • Double basket flexibility in a single pan fryer <p>FR25 & F28 Fryers</p> <ul style="list-style-type: none"> • Two pans and two baskets • Double the quantities, stagger orders, keep food separate
---	--

SPECIFICATIONS

MODEL	TANK CAPACITY	NO. OF BASKETS	PRODUCT DIMENSIONS w x d x h (mm)	POWER Watts	CURRENT Amps	HEAT UP TIME, MINS (25-180° C)	THAWED CHIPS PROD, Kg/Hr	FROZEN CHIPS PROD, Kg/Hr
FR15	1 x 5 Ltr pan	1	290 x 480 x 335	2300	10.0	11	7	6.5
FR18	1 x 8 Ltr pan	1	290 x 480 x 385	3450	15.0	13	10.5	10
FR111	1 x 11 Ltr pan	2	555 x 480 x 335	3450	15.0	18	14	12.5
FR25	2 x 5 Ltr pans	2	570 x 480 x 335	2 x 2300	2 x 10.0	11	14	13
FR28	2 x 8 Ltr pans	2	570 x 480 x 385	2 x 3450	2 x 15.0	13	21	20



FR15



FR18



FR111



FR25



FR28

DIMENSIONS All measurements are in millimetres ~

FR15

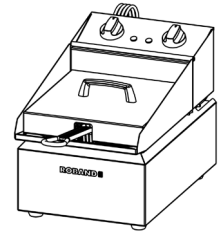
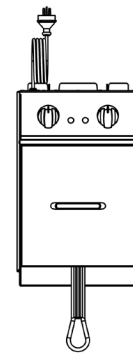
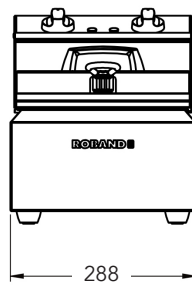
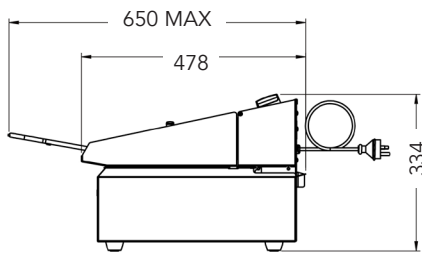

FR18

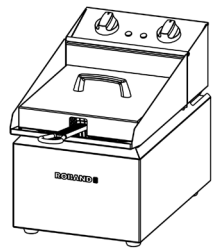
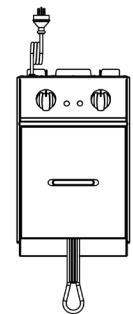
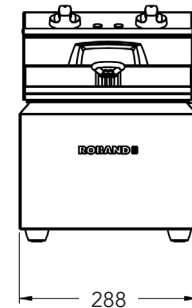
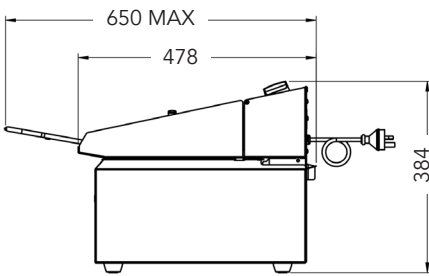

FR25

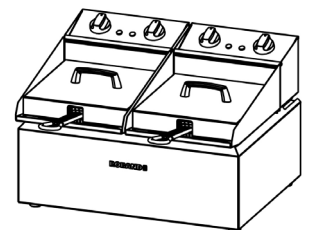
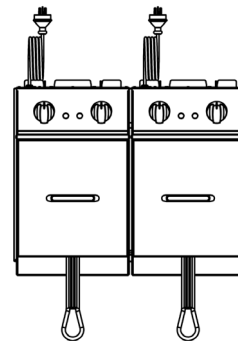
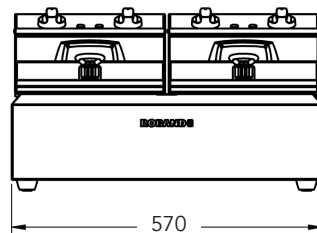
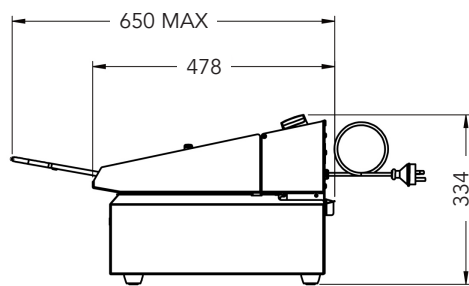

FR28

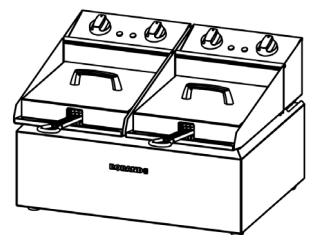
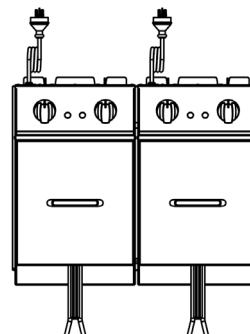
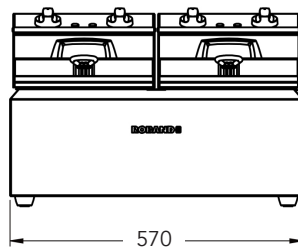
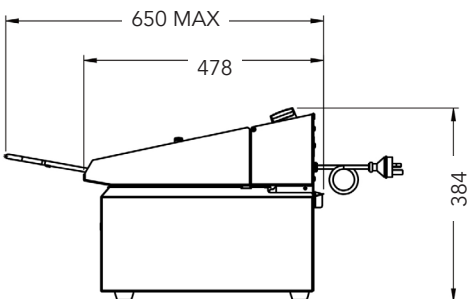

FR111

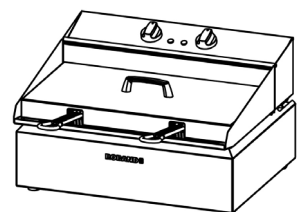
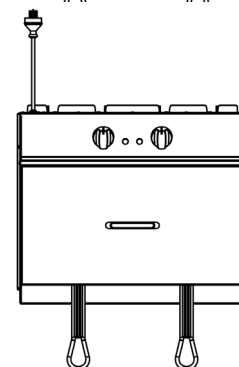
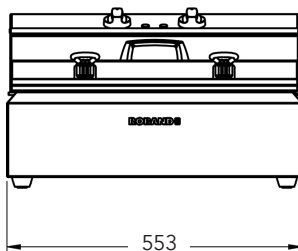
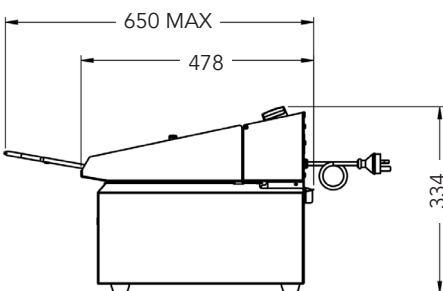

~Line drawings not to scale